

Mortise Cylinders

Part numbers:

- CL-M2N 1-1/8", nickel finish
- CL-M2B 1-1/8", brass finish
- CL-M4N 1-1/4", nickel finish
- CL-M4B 1-1/4", brass finish



The CyberLock mortise cylinder is available in two different sizes and two different finishes: 1-1/8" and 1-1/4", brass and nickel finishes.

The CyberLock mortise cylinder is manufactured to the exact dimensions of a Schlage mechanical mortise cylinder, which makes for easy conversion in the field. The cylinder ships with a standard large mortise lock cam on the back or can be converted in the field with other cams that are compatible with the Schlage-style mortise cams.

Notes:
All dimensions in inches
Drawing not to scale

Part numbers:
CL-M2N and CL-M2B

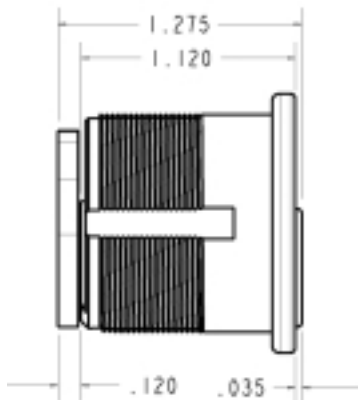

Part numbers:
CL-M4N and CL-M4B

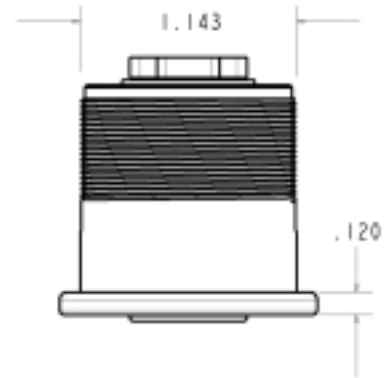
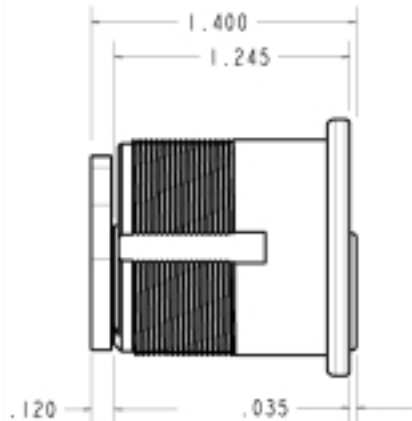

Mortise Cylinders

Part numbers:

CL-M2N	1-1/8", nickel finish
CL-M2B	1-1/8", brass finish
CL-M4N	1-1/4", nickel finish
CL-M4B	1-1/4", brass finish

Specifications

Finish	Nickel or brass plating
Operating Temperature	-40° to 160° F; -40° to 70° C
Power Requirements	None; power supplied by battery in key
Access Schedule	Individual schedule programmed into CyberKey provides complete control over specific days, times during selected days, and holidays
Access Options	Standard one key access; multiple key custody of up to four keys to open lock; delayed access
Key Limitation	No limit to number of keys that lock cylinder can support
Audit Capacity in Lock	Last 1100 events with date and time